

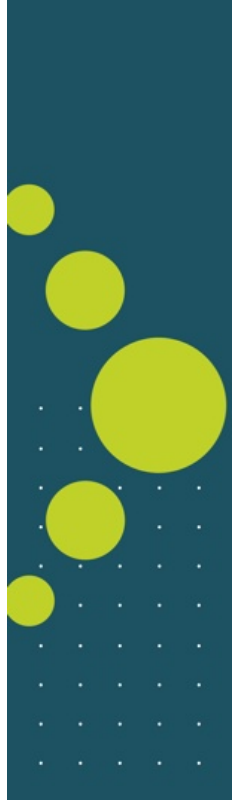

# Agenda



<b>11:00-11:05</b>	<b>Welcome</b>	<b>Norbert Klapper, CEO Kurt Ledermann, CFO</b>
<b>11:05-11:30</b>	<b>Presentation and Q&amp;A</b>	<b>Norbert Klapper</b>
<b>11:30-12:00</b>	<b>Booth Tour</b>	<b>Norbert Klapper</b>
<b>12:30-13:00</b>	<b>Lunch</b>	

# The Most Economical Direct Rotor Process

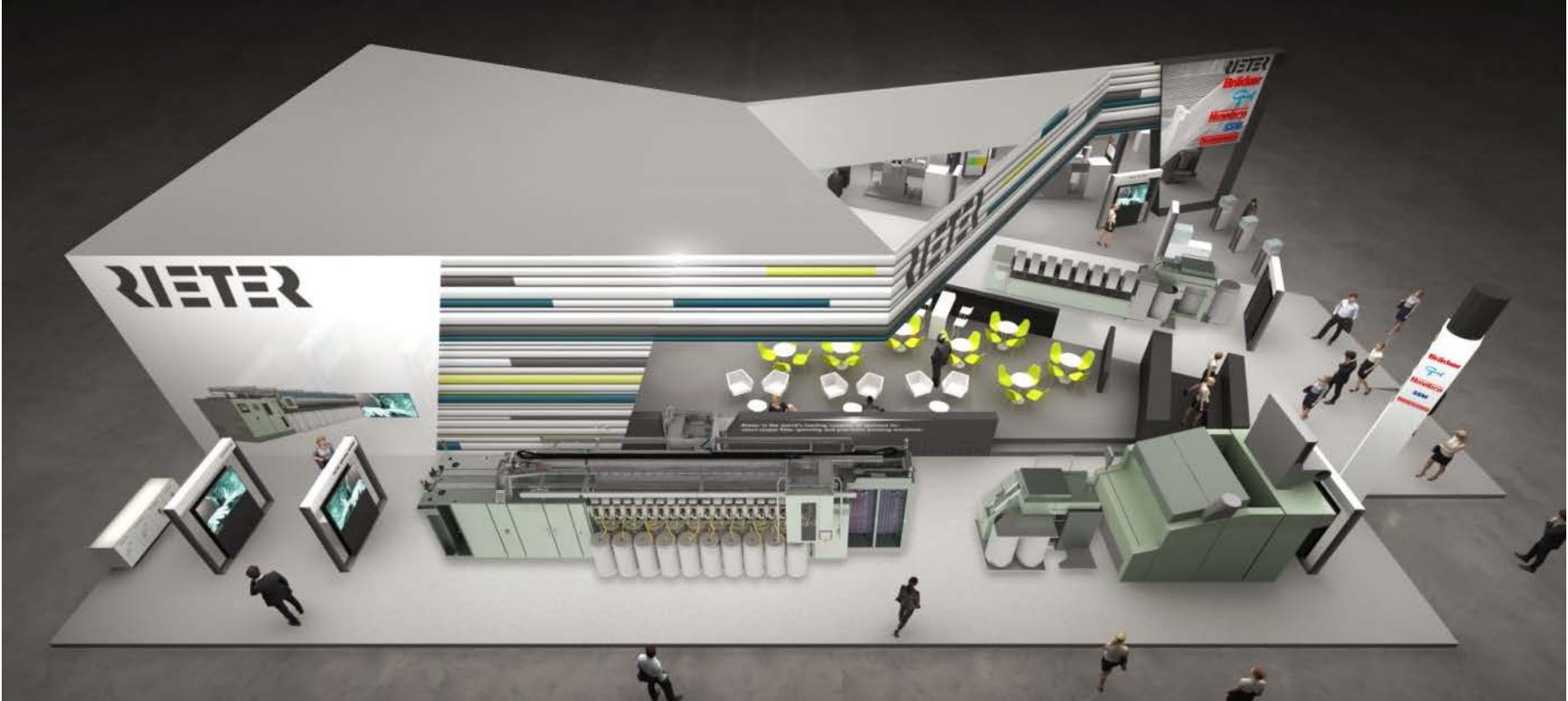

# The Most Economical Direct Rotor Process

RIETER



## C 80

### Card

The card C 80 produces 30% more card sliver. The significantly larger carding area forms the basis for high productivity, best sliver quality with 10% fewer imperfections or raw material savings.

## RSB-Module 50

### Autoleveler draw frame module

The RSB-Module 50 is based on the successful established technology of the autoleveler draw frame RSB-D 50. It features two draft zones for outstanding yarn evenness.

## R 37

### Semi-automated rotor spinning machine

The R 37 features impressively high productivity, very high raw material flexibility, and low energy consumption. The proven user-friendly machine concept can be enhanced through automation of the package change.

## R 70

### Fully automated rotor spinning machine

The optimum raw material utilization, maximum productivity and yarn quality, and the low energy consumption of the fully automated rotor spinning machine R 70 are setting new standards on the market.

# News from the Inventors of Compacting

**RIETER**

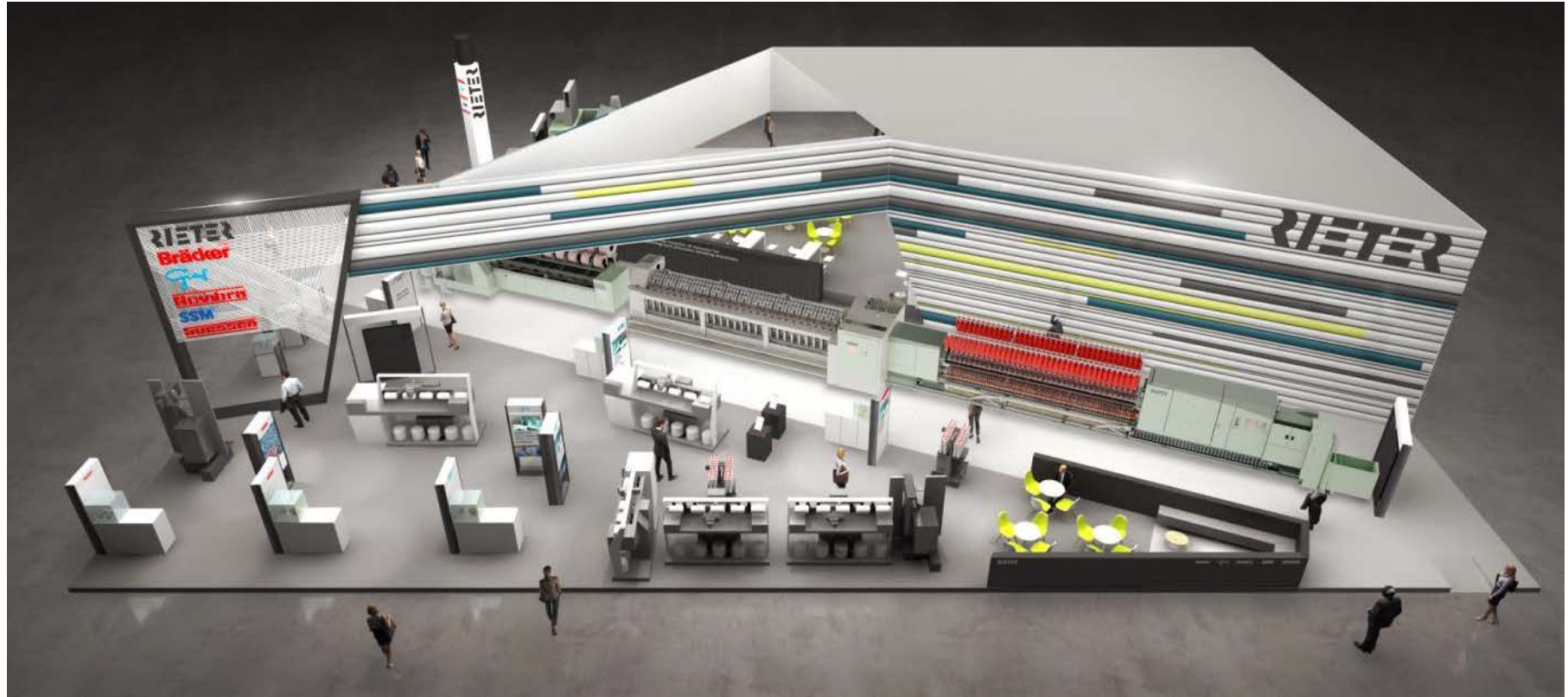



# News from the Inventors of Compacting

**E 90**  
**Comber**  
The latest machine from the market leader of combers offers a wider range of applications and maximum yarn quality with 10% greater sliver production.

**F 40**  
**Fully automated roving frame**  
The F 40 is equipped with the fastest doffer on the market – ensuring a high level of productivity. The unique doffing system enables short downtimes and thus high efficiency. The roving frame with up to 252 spinning positions reduces production costs.

**COMPACTdrum  
COMPACTapron  
COMPACTeasy**  
**Compacting devices**  
The new compacting device family offers compacting solutions that are easy to install and remove. Conventional ring yarns and compact yarns can be spun on the same machine. The variety of devices offers the ideal solution for every requirement.

**G 38**  
**Ring spinning machine**  
The ring spinning machine G 38 flexibly produces high-quality standard and special yarns with high performance. Thanks to the low energy consumption and savings in personnel costs, it makes spinning highly profitable.

**ROBOspin**  
**Piecing robot**  
The piecing robot in ring spinning enables a highly automated spinning process. The personnel requirements can be significantly reduced.

# Air-Jet Spinning

**RIETER**

Innovative cotton yarn economically produced



# Air-Jet Spinning

---

Superior cotton fabric characteristics:

- Soft touch
- Even surface (ideal for printing)
- Resistance to pilling and washing
- Shape retention
- Intense colors





# ESSENTIAL – Rieter Digital Spinning Suite



## Key Benefits

- Eliminate inefficiencies along the spinning process
- Provide expertise through system intelligence
- Automate repetitive labor

# ESSENTIAL Offering



Customer Value

Modules

Features

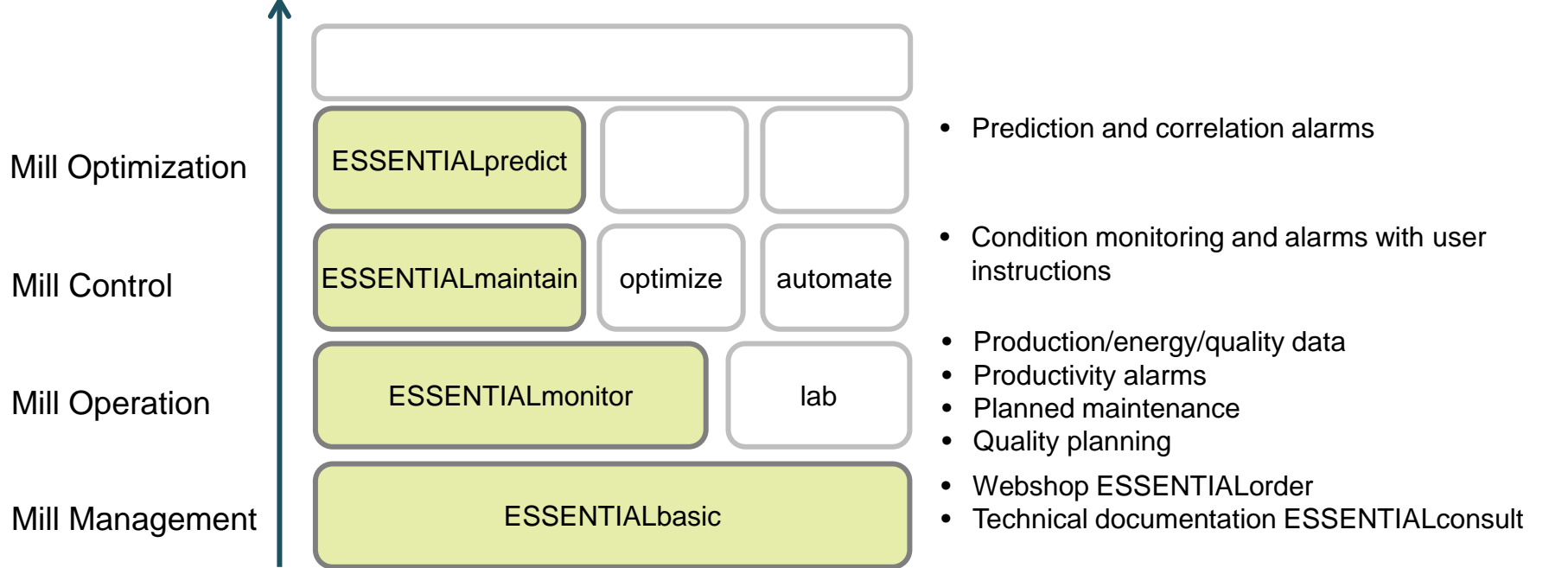

ITMA 2019

Future Modules

Solutions for optimizing the installed base of Rieter machines

## Highlights

- PSM Drafting Motor for ring spinning machines
- Energy Saving Support Disc for rotor spinning machines



Energy Saving Support Disc

## Highlights

Bräcker: Ring traveler C1 ELM udr  
for ring spinning machines

Suessen: SOLIDRING B 188  
for rotor spinning machines

SSM: *preciforce*  
precision winding control  
  
*powerblade*  
precision winding XENO-PB

*fancyflex*  
texturized slub yarn

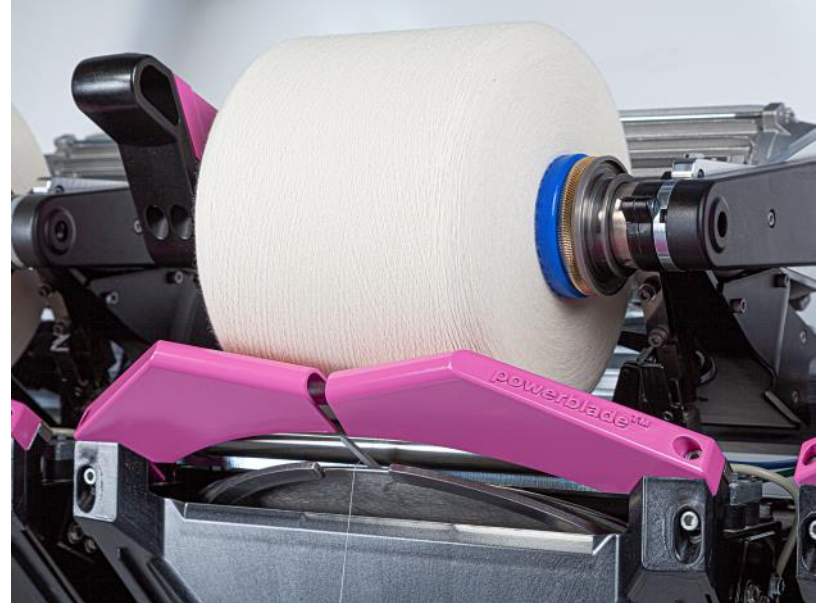

SSM *powerblade*, the next generation of blade winding

# Making More Money with Rieter



Example: Compact yarn – comparison competitor's system vs. Rieter system<sup>1)</sup>

Production of 413 kg/h yarn with a count of Ne 60 – Rieter benefits

- Space requirement -750 m<sup>2</sup>
- Raw material utilization +1%
- Energy consumption -10%
- Personnel requirement -6%

**Additional cash flow of around**

**USD 400 000 per year**

<sup>1)</sup> Raw material cost, yarn price the same





# Thank You for Your Attention

**RIETER**

